

Technical Datasheet

Product Code: **HARWHPAN**

Product Description: **RAK Moon WH Pan**

Specification

Product Guarantee:	25 Years
Barcode:	5056176001582
Packaged Weight (kg):	29.5 kg
Material:	Vitreous China
Projection:	560
Style:	Modern
Made In the UK:	No
Includes Seat:	No



Key Features

- Wide-ranging bathroom collection with modern expressive design
- The natural raw materials make ceramic hard wearing, scratch-proof & resistant to limescale
- Wall hung WC maximises floor space & makes cleaning easy
- Suitable for use with concealed cisterns & wall hung frames
- Optional seats are available to purchase separate

Technical Drawing

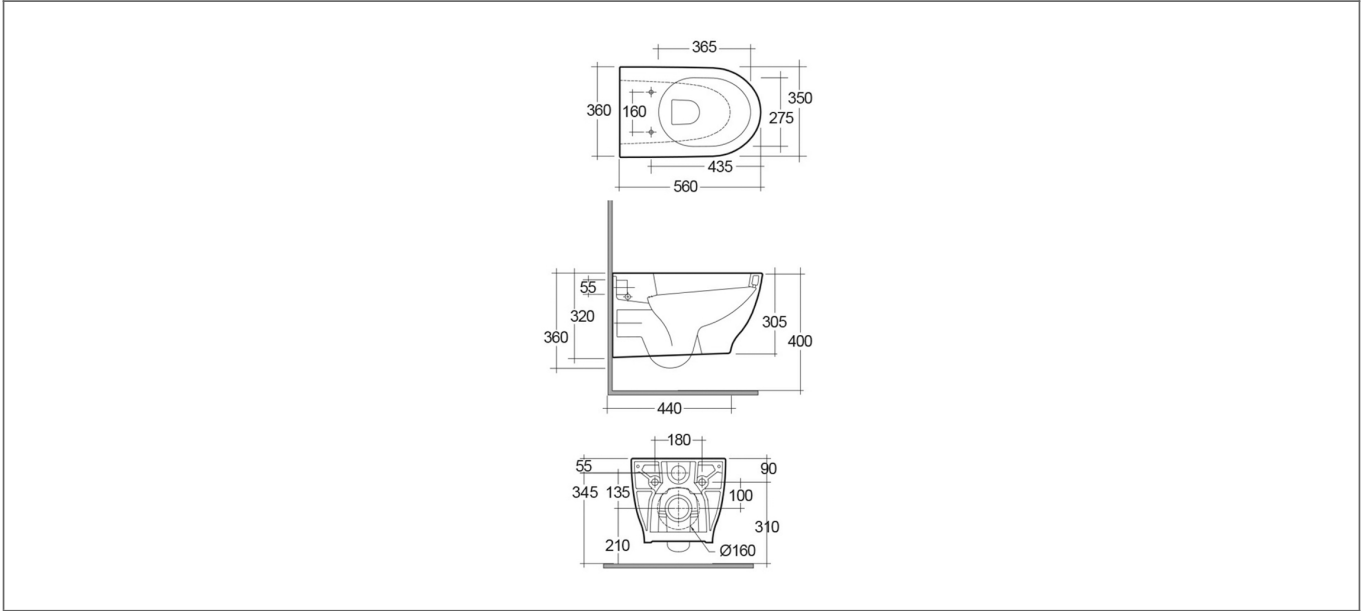

Dimensions: All measurements are in millimetres and are subject to normal manufacturing variations.

Due to a continuing development programme to improve design and performance, we reserve all rights to vary specifications without prior notice. Please note, all accessories are for photographic purposes only.