

# Technical Datasheet

Product Code: **SY-BLE30TUC**



Product Description: **Synergy Blend 300mm Tall Unit Clay**

## Specification

Number Of Doors:	2
Number Of Shelves:	4
Handle Type:	Pull
Material:	MFC
Style:	Contemporary
Product Guarantee:	Lifetime
Barcode:	5056474508899
Packaged Weight:	40 kg
Packaged Length (Metre):	0.37
Packaged Width (Metre):	0.315
Packaged Height (Metre):	1.955



## Key Features

- Create an aesthetic that is part of the constantly evolving contemporary style of present day
- Manufactured from high quality materials
- Coated in a luxury clay finish
- Space saving design ideal for all your bathroom essentials
- Other colours & sizes are available too choose from

## Technical Drawing

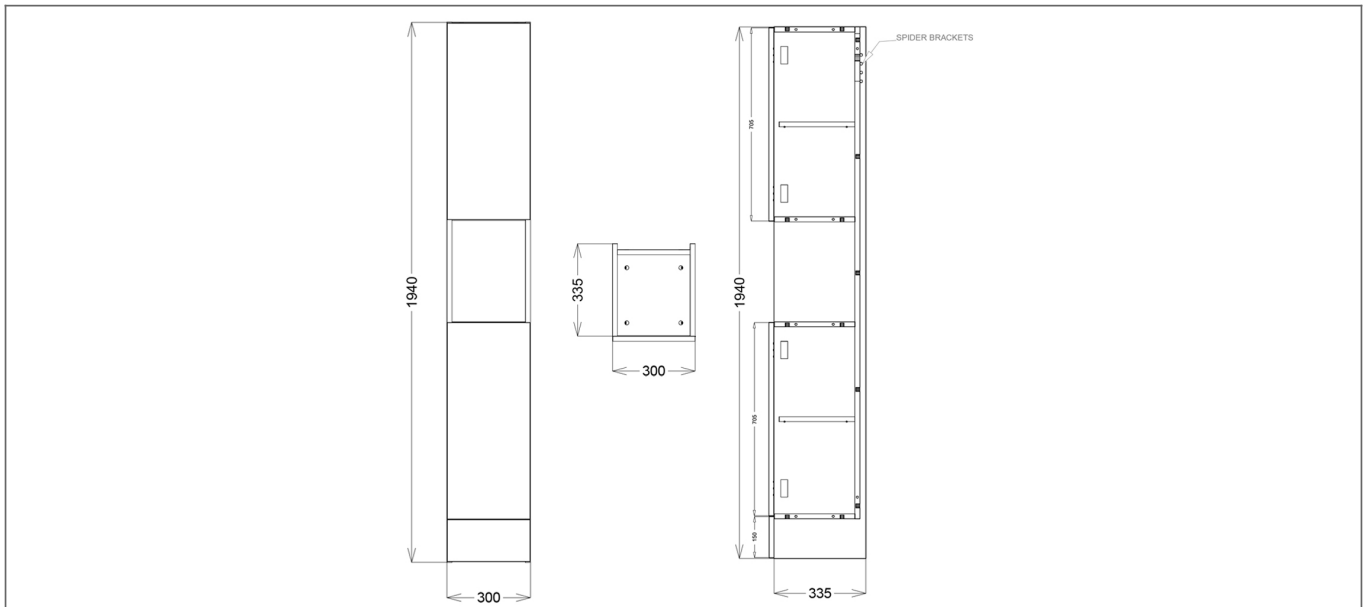

Dimensions: All measurements are in millimetres and are subject to normal manufacturing variations.

Due to a continuing development programme to improve design and performance, we reserve all rights to vary specifications without prior notice. Please note, all accessories are for photographic purposes only.