

Technical Datasheet

Product Code: **SY-BLE30BUFDMW**



Product Description: **Synergy Blend 300mm Base Unit Matt White**

Specification

Number Of Drawers:	0
Number Of Doors:	1
Number Of Shelves:	1
Handle Type:	Pull
Material:	MFC
Style:	Contemporary
Product Guarantee:	Lifetime
Barcode:	5056474508936
Packaged Weight:	14 kg
Packaged Length (Metre):	0.37
Packaged Width (Metre):	0.315
Packaged Height (Metre):	0.879



Key Features

- Create an aesthetic that is part of the constantly evolving contemporary style of present day
- Manufactured from high quality materials
- Coated in a luxury matt white finish
- Space saving design ideal for all your bathroom essentials
- Other colours & sizes are available too choose from

Technical Drawing

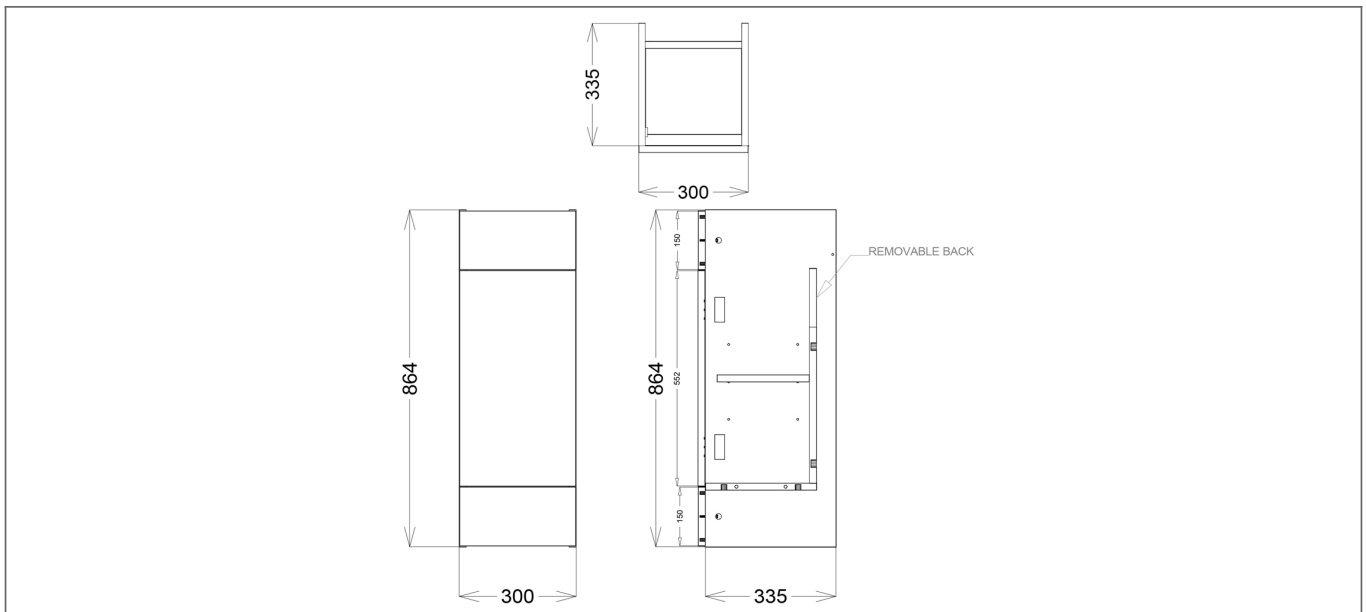

Dimensions: All measurements are in millimetres and are subject to normal manufacturing variations.

Due to a continuing development programme to improve design and performance, we reserve all rights to vary specifications without prior notice. Please note, all accessories are for photographic purposes only.