

Technical Datasheet

Product Code: **237091-D**

Product Description: **ARLEY Wall Hung Pan & Seat In A Box**



Specification

Product Guarantee:	Lifetime
Barcode:	5056474523748
Packaged Weight (kg):	17.4 kg
Material:	Vitreous China
Projection:	521
Style:	Modern
Made In the UK:	No
Approvals:	CE Approved
Includes Seat:	Yes
Seat Type:	Standard



Key Features

- Wide-ranging bathroom furniture collection with modern expressive design
- Manufactured from high quality materials
- Wall hung pan design creates the illusion of more floor space
- Suitable for use with concealed cisterns & wall hung frames
- Matching sanitaryware are also available in the Arley range
- Complete with standard seat

Technical Drawing

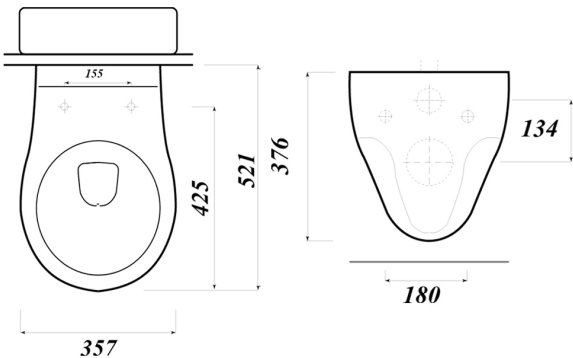

Dimensions: All measurements are in millimetres and are subject to normal manufacturing variations.

Due to a continuing development programme to improve design and performance, we reserve all rights to vary specifications without prior notice. Please note, all accessories are for photographic purposes only.